

UNILATERAL

Frames for two doors side by side

Unilateral frame allows two opposite doors to slide into the same pocket. It requires only a single frame's overall dimension, but it hosts two parallel doors going in opposite directions. It is ideal when you have two parallel doors and a short wall space like corridor and hall entrances.

Finished wall thickness 175mm

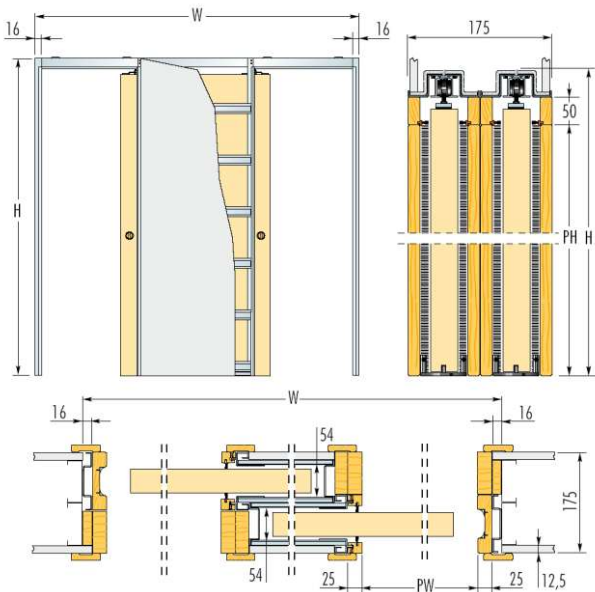
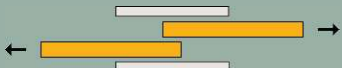

N.B. Non standard sizes on request



N.B.: Always specify door handings

AVAILABLE ACCESSORIES

- Soft Close
- Self Closing Mechanism
- Door Furniture

See accessories PDF for further details

FURTHER INFORMATION

0113 245 9559
 info@em-b.co.uk
 www.em-b.co.uk

www.pocketdoors.co.uk
ECLIPSE
POCKET DOORS.co.uk

FRAMES FOR 2 DOORS SIDE BY SIDE

Max Passage Size PW x PH	Overall Dimension W x H	Finished Wall	DOOR PANEL UK	
			Standard DW	DH
600 x 2030	1982 x 2115	175	626	2040
700 x 2030	2282 x 2115	175	726	2040
800 x 2030	2582 x 2115	175	826	2040
900 x 2030	2882 x 2115	175	926	2040
1000 x 2030	3182 x 2115	175	1026	2040
585 x 1971	1952 x 2056	175	2ft. 0in. x 6ft. 6in. (610 x 1981mm)	
661 x 1971	2204 x 2056	175	2ft. 3in. x 6ft. 6in. (686 x 1981mm)	
737 x 1971	2456 x 2056	175	2ft. 6in. x 6ft. 6in. (762 x 1981mm)	
813 x 1971	2608 x 2056	175	2ft. 9in. x 6ft. 6in. (838 x 1981mm)	
900 x 1971	2882 x 2056	175	3ft. 0in. x 6ft. 6in. (914 x 1981mm)	

NOTES

- Suitable for use with 35-44mm thick doors
Max door weight 80kg (120kg on request)
- When fitting flush pull handles we recommend the stop be regulated so the door protrudes from the pocket to avoid risk to fingers.
- Should the door be set to enter the pocket completely we do not accept any liability
- Doors, plasterboard and final architrave are not supplied

Dimensions are given in mm